

LED TYPE 200 POWER FEED

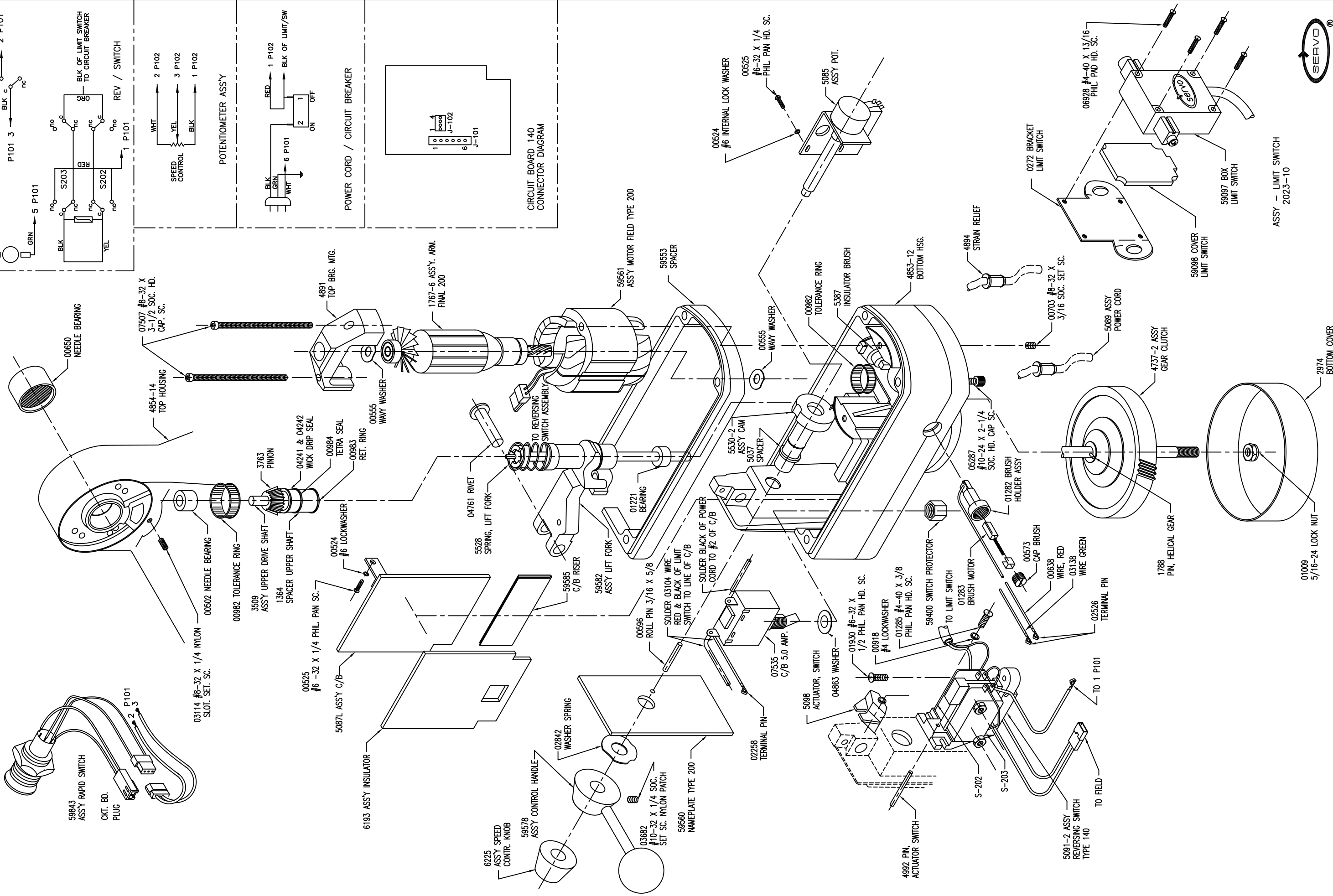
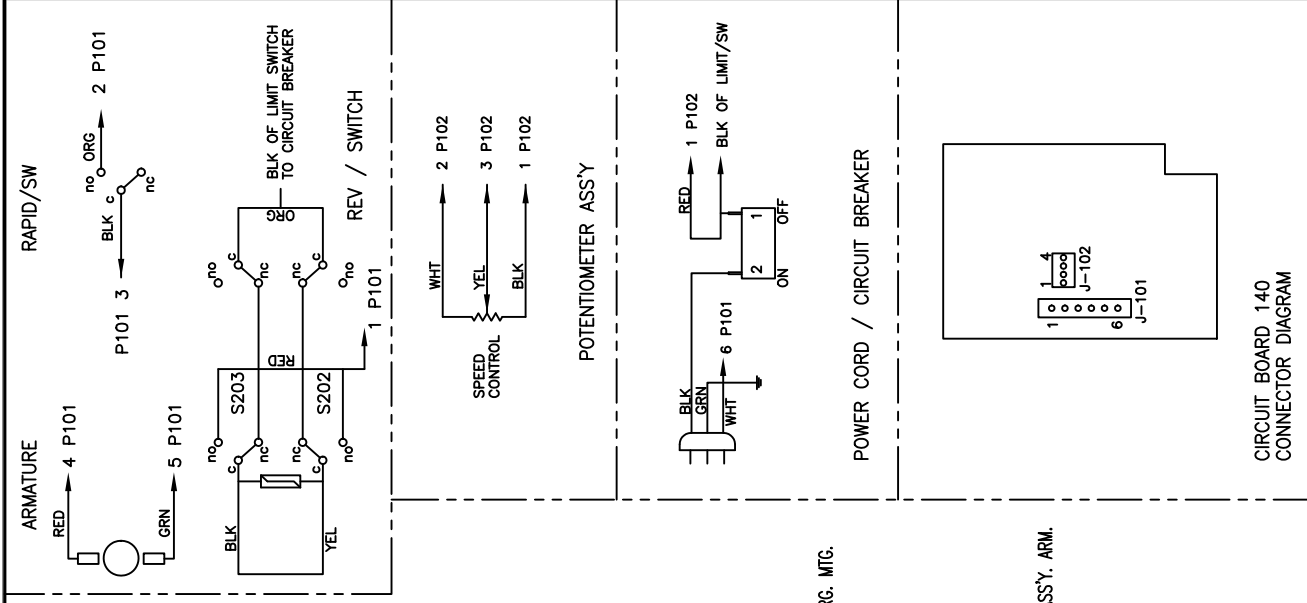

DWG. NO. : 59584L

07-10-15 0800-80919L

TYPE 200 SERVO DRIVE



ASSY - LIMIT SWITCH 2023-10

Need to change tools quickly?

See our Power Drawbar on the web at www.ServoProductsCo.com or phone 800-521-7359 or 440-942-9999 and request information on the

SERVO® Power Drawbar



Comes complete with regulator, gauge, filter lubricator, drawbar, mounting hardware and instructions. The Power Drawbar helps to reduce operator fatigue and eliminates excessive downtime. It takes only a few minutes to install and seconds to learn. No special tools are required to install the Power Drawbar, it comes complete with a limited warranty and is American made.

We also have:

- Variable Frequency Drives
- Precision Drill Presses
- Lube Pumps
- Accessories - Vises, Collet Sets, Grinders & Fixture Plates
- Import Power Feeds

The Servo 50th Anniversary LED - Type 200 Power Feed



The 50th Anniversary Type 200 Power Feed features our new LED rapid switch technology. This new and improved design increases the reliability of the rapid switch function and also improves the visibility of the power on indicator.

ORDERING INSTRUCTIONS

1. Please specify the type, model number, and serial number of the unit for which parts are being ordered.
2. The limit switch bracket, limit switch assembly, and bevel gear are determined by model number.
3. Note that parts are listed by assembly. They may be ordered as complete assemblies or as individual parts.

REPAIRS

For repairs, contact Servo Products Company for the location of your authorized Service Center or see our website.

REPAIR POLICY

These conditions must be met for an authorized service center to accept returned goods from customers for in-warranty or out-of-warranty repairs.

1. The freight must be prepaid on all products sent to an authorized service center for warranty repair. The service center will pay the return freight on all products under warranty. The service center will repair or replace, at their own option, products which prove to be defective during the warranty period.
2. The freight will be paid by the customer both ways on products which are not under warranty and the repaired item will be returned C.O.D. Contact Servo Products Company for the location of authorized service centers or see our website.

WARRANTY

All Servo Products Company products are warranted against defects in material and workmanship. This warranty applies for one year from the day of delivery to the customer. We will repair or replace at our own option products which prove to be defective during the warranty period, provided they are returned to Servo Products Company, freight prepaid. This guarantee does not include repair or replacement required because of misuse, abuse or normal wear and tear. Repairs made by other than the factory or an authorized service center terminate Servo Products Company's liability under this guarantee. This guarantee is made expressly in place of all other guarantees or warranties, expressed or implied, with respect to quality, merchantability, or fitness for a particular purpose.

SERVO PRODUCTS COMPANY

34940 Lakeland Blvd, Eastlake, OH U.S.A. 44095
 Phone: 440.942.9999 or 800.521.7359 Fax: 440.942.9100
 Website: www.ServoProductsCo.com
 Email: techsupport@ServoProductsCo.com

PARTS LIST

Qty	Part No.	Description
1	5085	Potentiometer Assembly
1	00541	Potentiometer, 500 ohm, 2-3/4" shaft
3	02258	Terminal pin, small
1	02260	Connector housing, 4 pin
1	04995	3/8" Washer, internal tooth, small
1	4897	Potentiometer bracket
1	5104	Potentiometer pilot
1	5091-2	Reversing Switch Assembly
1	01294	MOV, 130 volt, 10 amp
2	01851	Pin
1	02526	Terminal pin, large
2	03033	4-40 x 1-1/8" Phillips pan head screw
2	03035	Micro switch, type V3, 15 amp
1	03094	Receptacle, male, 2 pin small
2	03598	4-40 hex lock nut, nylon
1	4893-2	Switch pedestal
1	59843	LED Rapid Switch Assembly
1	59582	Lift Fork Assembly (includes Lower Drive Shaft)
2	00564	Roll pin 1/8 x 5/8"
1	01220	Fiber washer
1	01334	Needle bearing
2	01335	Bearing race
1	01809	Steel dowel 1/8 x 1/2"
1	59251	Spring, lower drive shaft
1	3457	Clutch
1	4908	Bearing cup
1	4909	Support lifter sleeve
1	59554	Lower drive shaft
1	4988	Cam follower
1	4989	Lift fork
1	59563	Spacer
1	4737-2	Nylon Gear & Hub Assembly
1	01061	Washer
3	02885	Spring washer
1	02886	Tru-arc retaining ring
1	02887	Thrust washer
1	4734	Gear hub
1	4735	Helical gear (without hub)
1	2023-10	Limit Switch Assembly – 6 foot cord

Servo Products Company reserves the right to make changes without notice or obligation in prices, specifications, or models.

Servo Products Company reserves the right to make changes without notice or obligation in prices, specifications, or models.